

ASSEMBLED

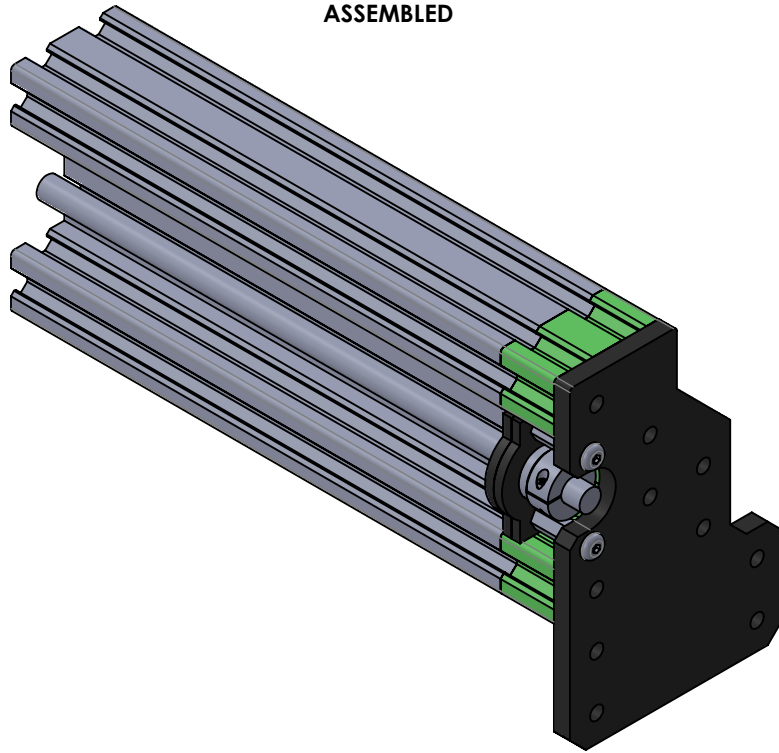

LEAVE GAP DURING ASSEMBLY
TIGHTEN SCREWS TO CLOSE GAP
& APPLY TENSION

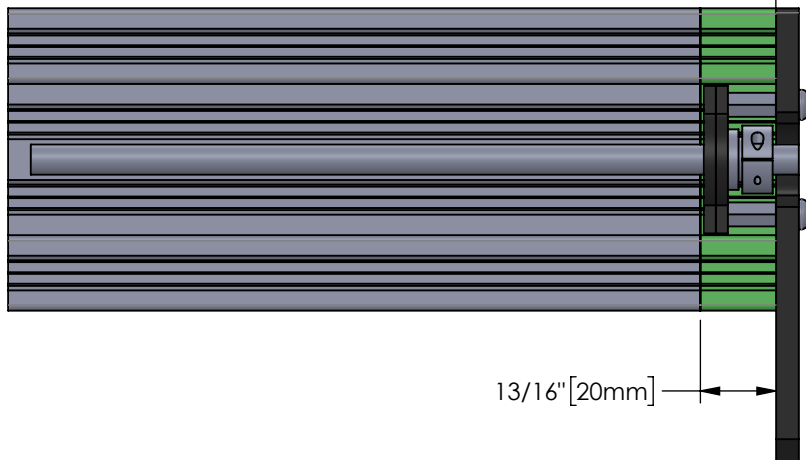

EXPLODED

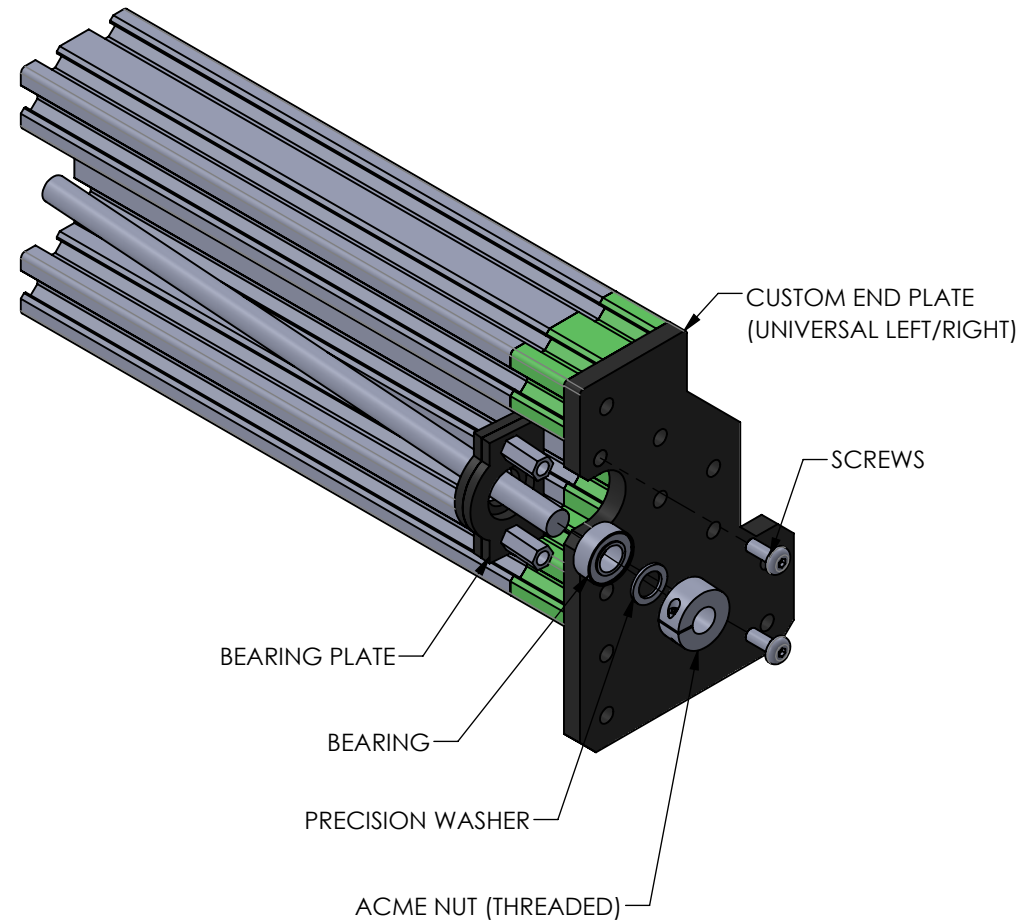

USED:

CUSTOM END PLATE: MODIFIED PROFILE W/ NOTCH FOR LEAD SCREW; HOLES FOR BEARING PLATE MOUNTING

STANDARD BEARING & PRECISION WASHER

THREADED LEAD SCREW NUT

INSTRUCTIONS:

ATTACH CUSTOM END PLATE TO RAIL END
INSTALL BEARING PLATE, BEARING, PRECISION WASHER AND ACME NUT
THREAD ON ACME NUT UNTIL BEARING PLATE POSTS ARE 1/16" SORT OF END PLATE
INSTALL SCREWS FROM FRONT & TIGHTEN TO APPLY TENSION TO LEAD SCREW
(THROUGH BEARING PLATE)